

LEVEL 3

LOT No. 94

LOCATION PLAN

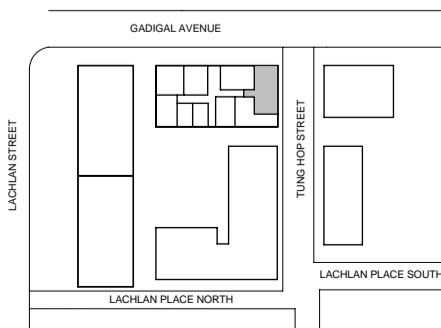

2 BEDROOM + MEDIA APARTMENT

Strata Area 102 m<sup>2</sup>

Areas subject to final survey, area includes balcony and/or terrace where applicable. It excludes parking and external storage areas.

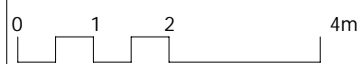
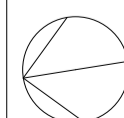

Please note that this floor plan was produced prior to completion of construction. The information contained herein is believed to be correct as at the date below. Dimensions and areas are approximate. Changes will undoubtedly be made during development without notice in accordance with the provisions of the contract for sale. The furniture and furnishings depicted are not included with any sale and furnishings should not be taken to indicate the final position of power points, TV connection points and the like, prospective purchasers must refer to the contract for sale for the list of inclusions. All graphics, including tile layout, balustrades, planting, louvres and sunshading devices, are indicative only. Bulkheads necessary for services are not depicted. Floor plans are at an unspecified scale. Plans do not show additional features within each lot such as hot water systems, service yards, letter boxes and external walls, fences and structures. Purchaser option for upgrades on fixtures and fittings (including fridges, laundry kits, floor finishes, tapware and bathroom fixtures) are not noted on floor plans are available for certain lots only and are only available at the cost of the purchaser at the time of sale. Correct as at: 09.06.17 [C]

- \* Fixed Screen
- # Non Trafficable Ledge

For further enquiries call 02 9080 8888 or visit [thefinery.mirvac.com](http://thefinery.mirvac.com)

